

“LI” 卫生级四通全包球阀

“LL TYPE” SANITARY 4 WAY  
ENCAPSULATED BALL VALVE

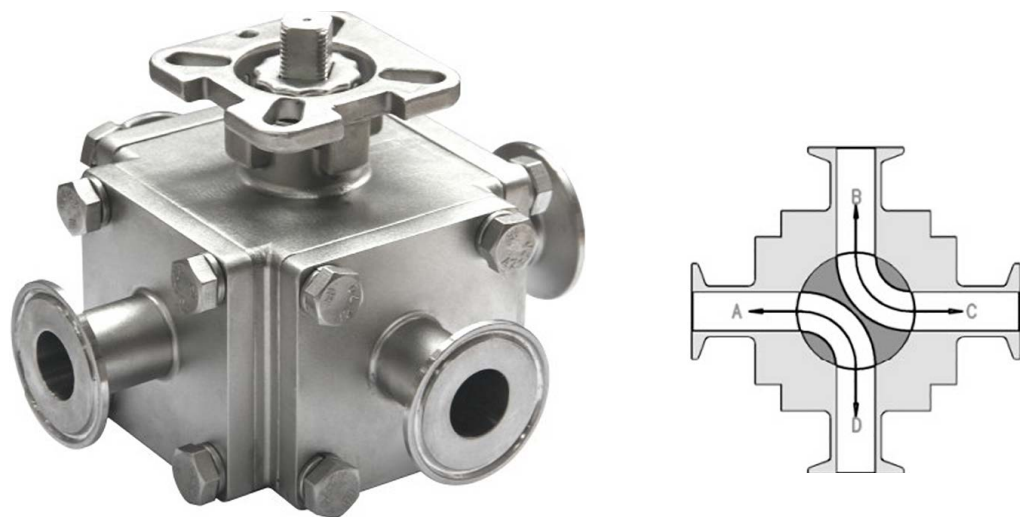

应用

可应用于食品、饮酒、酿酒、炼油、化妆品、制药和化学制品行业中要求无滞留同时对两种介质的流向进行切换的管道。

产品特点：

- 1、本系列阀门可配多种驱动装置。
- 2、本系列阀门介质流向工作原理：
  - 如图所示，该四通换向球阀，一 阀实现正反供水切换，每转90°，供水方式切换一次，可同时对两种介质的流向进行切换，即方便而迅速，实现一阀多用的效果。
  - 以前需四个阀门，供水时阀A、D 开启，阀B、C关闭，反向供水时阀B、C开启，阀A、D 关闭，现用一台四通球阀替代，操作方便。
- 3、本系列阀门的特点：
  - 流体阻力小 球体和阀体的连接管道截面相等，且球体通道采用圆弧连接，介质通过球体是，流体阻力小。
  - 密封性能好：阀座采用具有一定弹性变形和高强度的PTFE材料，达到良好密封性能保证了阀门的稳定性。
  - 使用寿命长：阀门的整体材质全部选用卫生级奥氏体不锈钢，阀座材料选用PTFE，能达到良好的抗腐蚀性作用，延长了阀门的使用寿命。
  - 无滞留设计 密封选用优质PTFE全包结构，使PTFE阀座与球体、阀体紧密接触，从而达到无滞留介质的功能。

“LI” 卫生级四通全包球阀

“LL TYPE” SANITARY 4 WAY  
ENCAPSULATED BALL VALVE



APPLICATIONS:

PIPE SYSTEM APPLIED IN FOOD, WINE, BREWERY, REFINING, COSMETICS, PHARMACEUTICAL AND CHEMICALS INDUSTRIES, REQUIRED NON-RETENTION AND SWITCH THE DIRECTION OF TWO MEDIA.

PRODUCT FEATURES:

- 1、 This series of valves can be equipped with a variety of drive devices.
- 2、 The working principle of this series of valve’ s medium flow direction:
  - As shown in the picture, the four-way reversing ball valve, one valve achieving positive and negative water supply switch, every 90° switch, mold of water supply changed, simultaneously switch the flow direction of two media, convenient and rapid, achieve the effect of multipurpose valve.
  - In the old time, supply water need four valves, when supply water, valve A, D opened, valve B, C closed; in opposite direction, valve B, C opened, valve A, D closed; but now only one valve can take place the four, easy to operate.
- 3、 Features of this series of valves:
  - Small fluid resistance: The connecting pipe section of the sphere and body are equal, and the spherical channel use arc connection, when the media through the sphere there has small fluid resistance.
  - Well sealing performance: valve seat use the PTFE material with a certain elastic deformation and high strength, reach the well sealing performance to make sure the stability of the valve.
  - Long-lasting usage: overall material of the valve choose sanitary authentic stainless steel, valve seat select PTFE material, can reach the good effect of corrosion resistance, to extend the usage life of the valve.
  - Non-stagnation design: sealing choose quality PTFE encapsulated structure, so that the PTFE seat, sphere and valve body contact closely, to reach the purpose of non-retention.

“LI” 卫生级四通全包球阀

## “LL TYPE” SANITARY 4 WAY ENCAPSULATED BALL VALVE

28/29



### APPLICATIONS:

PIPE SYSTEM APPLIED IN FOOD, WINE, BREWERY, REFINING, COSMETICS, PHARMACEUTICAL AND CHEMICALS INDUSTRIES, REQUIRED NON-RETENTION AND SWITCH THE DIRECTION OF TWO MEDIA.

### PRODUCT FEATURES:

- 1、 This series of valves can be equipped with a variety of drive devices.
- 2、 The working principle of this series of valve' s medium flow direction:
  - As shown in the picture, the four-way reversing ball valve, one valve achieving positive and negative water supply switch, every 90 switch, mold of water supply changed, simultaneously switch the flow direction of two media, convenient and rapid, achieve the effect of multipurpose valve.
  - In the old time, supply water need four valves, when supply water, valve A, D opened, valve B, C closed; in opposite direction, valve B, C opened, valve A, D closed; but now only one valve can take place the four, easy to operate.
- 3、 Features of this series of valves:
  - Small fluid resistance: The connecting pipe section of the sphere and body are equal, and the spherical channel use arc connection, when the media through the sphere there has small fluid resistance.
  - Well sealing performance: valve seat use the PTFE material with a certain elastic deformation and high strength, reach the well sealing performance to make sure the stability of the valve.
  - Long-lasting usage: overall material of the valve choose sanitary authentic stainless steel, valve seat select PTFE material, can reach the good effect of corrosion resistance, to extend the usage life of the valve.
  - Non-stagnation design: sealing choose quality PTFE encapsulated structure, so that the PTFE seat, sphere and valve body contact closely, to reach the purpose of non-retention.

# “LI” 卫生级四通全包球阀

## “LL TYPE” SANITARY 4 WAY ENCAPSULATED BALL VALVE

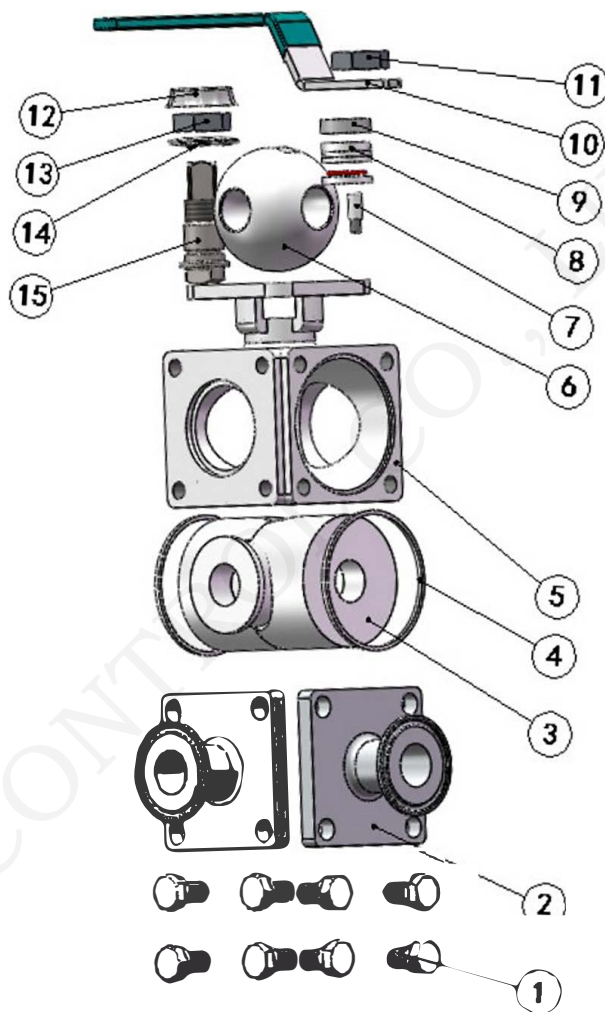

NO.	DESCRIPTION		
01	螺栓/Bolt	09	压套/Gland
02	阀盖/bonnet	10	手柄/hand shank
03	阀座Seat	11	螺母/Nut
04	密封线条/Sealing	12	止退垫/Check back pad
05	阀体/Body	13	螺母/Nut
06	球体/Ball	14	碟簧/disc spring
07	限位销/spacer pin	15	阀杆/Stem
08	组合填料/combined packing		